

# 螺母 Nut

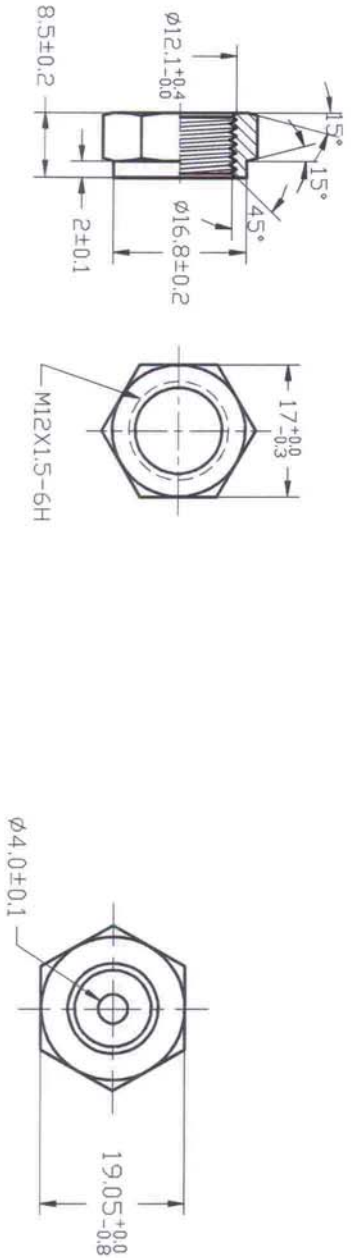

## 垫片 Washer

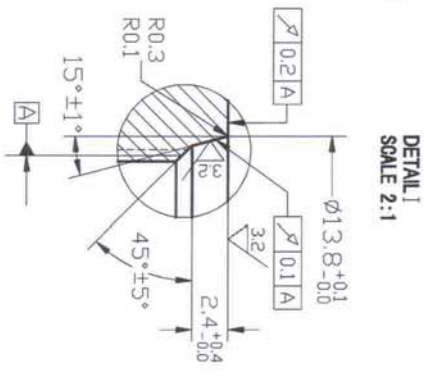
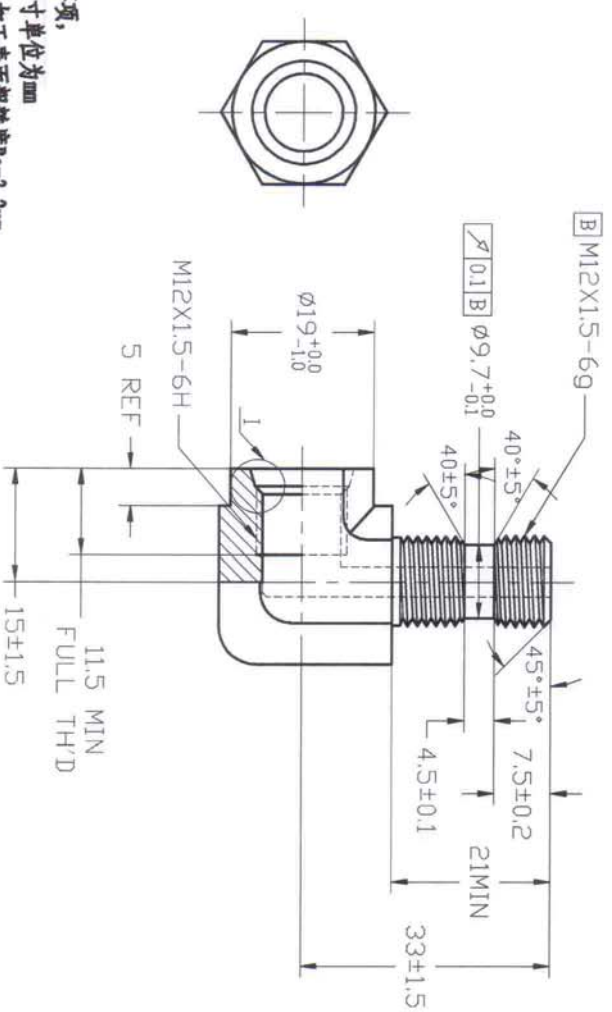
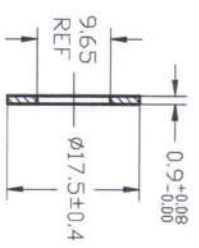

UNLESS SPECIFIED  
ALL DIMENSIONS IN mm  
MACHINED SURFACES Ra=3.2um  
ANGLE TOLERANCES ±1°  
Other tolerance except angles,  
in accordance with  
GB/T1804-2000(ISO2768-1)m  
and GB/T1184-1996(ISO2768-2)-m

其它事项,  
图示尺寸单位为mm  
未注机械加工表面粗糙度Ra=3.2um  
角度公差±1°  
其它未注公差 (除角度外) 均按:  
GB/T1804-2000 (ISO2768-1)-m和  
GB/T1184-1996 (ISO2768-2)-m

MATERIAL Chinese steel 45

FINISH Remove all sharp edges,burrs,silvers and swarf, break all edges 0.127-0.254mm. 去除所有毛刺, 去除各尖角, 倒边倒角0.127-0.254mm. ZINC PLATED WITH TRIVALENT CHROMATE AND NO RED CORROSION IN 96 HOURS SALT SPRAY TEST. 镀锌, 三价铬钝化, 银白色, 96小时盐雾试验无红斑.

REV	DATE	REVISION DETAILS	APPD
更改号	日期	更改内容	审核并批准

PART NO 零件名	41052-M12PT-M12NWO
SCALE:	APPD: Zhangjian 批准
NTS	DATE: 22/04/15 日期
	DRN: Tangha lilong 制图 2015.04.15
	CHK: LITandiao 审核 2015.04.15